

AircoHeater



A+ / A+



| | | | | | | |
|----------------------|-----------------------------|-----------------|---------------------|----------------------------|---------------------------------|------------------|
| Binnenunit | Type | AB36RIY | | Type | | Unité intérieure |
| | Fabriekscode | ABHG-36LRTE | | Fabriekscode | | |
| Buitenunit | Type | AOB36RIY | | Type | | Unité extérieure |
| | Fabriekscode | AOHG-36LETL | | Fabriekscode | | |
| Koelmiddel | | R410A | | | | Réfrigérant |
| Verwarming (*) | Vermogen (+7°C) | kW | 11,2 (2,7~12,7) | kW | Puissance (+7°C) | Chauffage (*) |
| | Electr.verm. (+7°C) | kW | 3,02 | kW | Puiss. absorb.nom (+7°C) | |
| | COP (+7°C) / SCOP(°) | | 3,71 / 4,1 (°) | | COP (+7°C) / SCOP (°) | |
| | Vermogen (+2°C) | kW | 4,68 | kW | Puissance (+2°C) | |
| | Electr.verm. (+2°C) | kW | 1,19 | kW | Puiss. absorb. (+2°C) | |
| | COP (+2°) | | 3,93 | | COP (+2°C) | |
| | Verm. max. bij -5°-10°-15°C | kW | 10,06/9,41/8,73 | kW | Puiss. max. à -5°-10°-15°C | |
| Koeling (*) | Vermogen | kW | 9,4 (2,8~11,2) | kW | Puissance | Refruid. (*) |
| | Electr.verm. | kW | 2,93 | kW | Puiss. absorb.nom | |
| | EER / SEER (°) | | 3,21 / 6,00 (°) | | EER / SEER (°) | |
| Pdesign | Verw. (Av.)(-10°C) / koelen | kW | 8,7 / 9,4 | kW | Chauff. (Av.)(-10°C) / refroid. | Pdesign |
| Jaarverbruik | Verw. (Av.) / koelen | kWh/jaar | 2965 / 548 | kWh/an | Chauff. (Av.) / refroid. | Consom. Annuel |
| Binnendeel | Debiet Q/L/M/H | m³/h | 1000/1200/1500/1900 | m³/h | Débit Q/L/M/H | Unité intérieure |
| | Geluidsdruk Q/L/M/H (1m) | dB(A) | 26/31/37/41 | dB(A) | Niv. son. press. Q/L/M/H (1m) | |
| | Geluidsvermogen H | dB(A) | 60 | dB(A) | Niv. son. puiss. H | |
| | Werkingslim. verwarmen | °C | 16~30 | °C | Plage de fonct. chauff. | |
| | Werkingslim. koelen | °C | 18~30 | °C | Plage de fonct. refroid. | |
| | Hoogte-breedte-lengte | mm | 240/1660/700 | mm | Hauteur/largeur/profond. | |
| | Gewicht | kg | 46 | kg | Poids | |
| Buitendeel | Geluidsdruk (1m) | dB(A) | 54 | dB(A) | Niv. son. press. (1m) | Unité extérieure |
| | Geluidsvermogen | dB(A) | 69 | dB(A) | Niv. son. puiss. | |
| | Debiet | m³/h | 3800 | m³/h | Débit | |
| | Compressor | | DC Rotary | | Compresseur | |
| | Werkingslim. verwarmen | °C | -15~24 | °C | Plage de fonct. chauff. | |
| | Werkingslim. koelen | °C | -15~46 | °C | Plage de fonct. refroid. | |
| | Hoogte-breedte-lengte | mm | 830/900/330 | mm | Hauteur/largeur/profond. | |
| Gewicht | kg | 61 | kg | Poids | | |
| Elektr.install. | Voeding | V | 230V/1F | V | Alimentation | Install. électr. |
| | Stroom max. verw./koel. | A | 20/18,5 | A | Amp. max chauff. / refroid. | |
| | Zekering traag | A | 25 | A | Fusible retardé | |
| | Hoofdvoeding aanbr.op | | Buiten/Ext. | | Unité à alimenter | |
| | Sectie voedingskabel | mm² | 3G4 | mm² | Section câble alimentation | |
| Sectie tssn bi en bu | mm² | 4G1,5 | mm² | Section entre int. et ext. | | |
| Tech.install. | Expansie | | Ext. | | Détente | Install. Techn. |
| | Koelleidingen | inch | 5/8 - 3/8 | inch | Lignes frigorifique | |
| | Standaardvulling-afstand | kg-m | 2,1 -20 | kg-m | Charge standard-distance | |
| | Bijvulling extra | g/m | 40 | g/m | Charge supplémentaire | |
| | Leidinglengte min-max | m | 3-50 | m | Longueur min / max | |
| | Hoogteverschil max | m | 30 | m | Dénivelé max | |
| | Diam. condensafvoer bi/bu | mm | 22 - 25,6 | mm | Diam. évac. condensat int/ext | |

(*) gegevens volgens de norm EN14511

(°) SCOP & SEER based on (EU)626/2011

(*) suivant la norme EN14511

Binnendeel

Unité intérieure

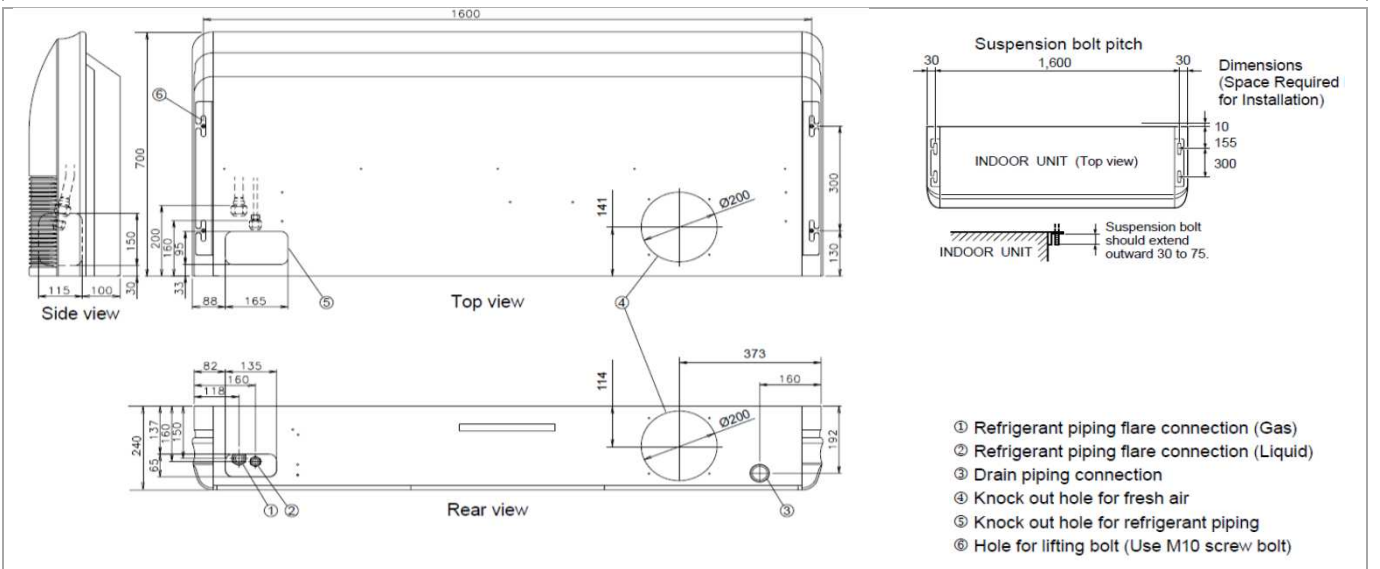

Buitendeel

Unité extérieure

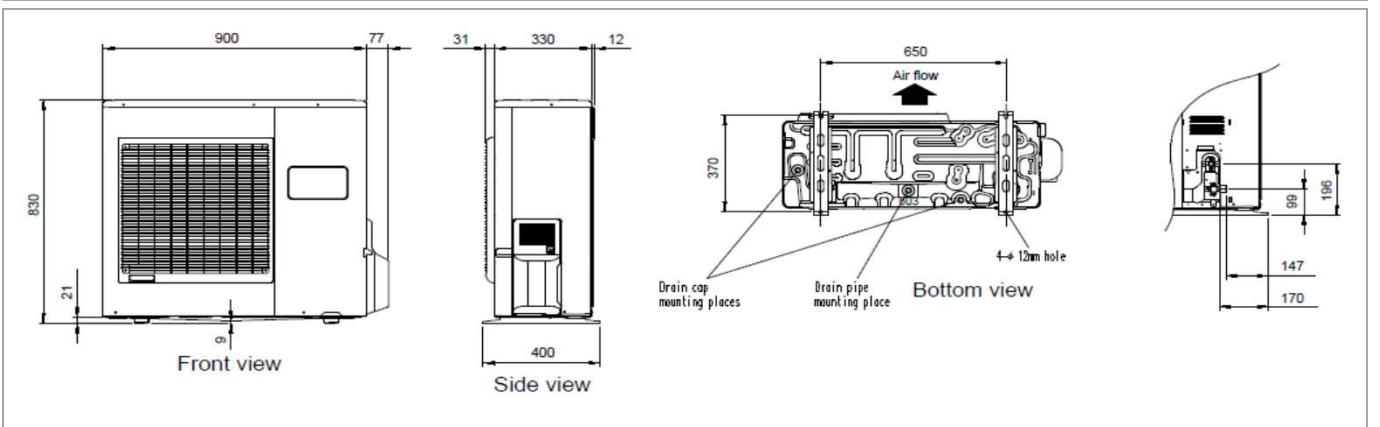

Montage

Montage

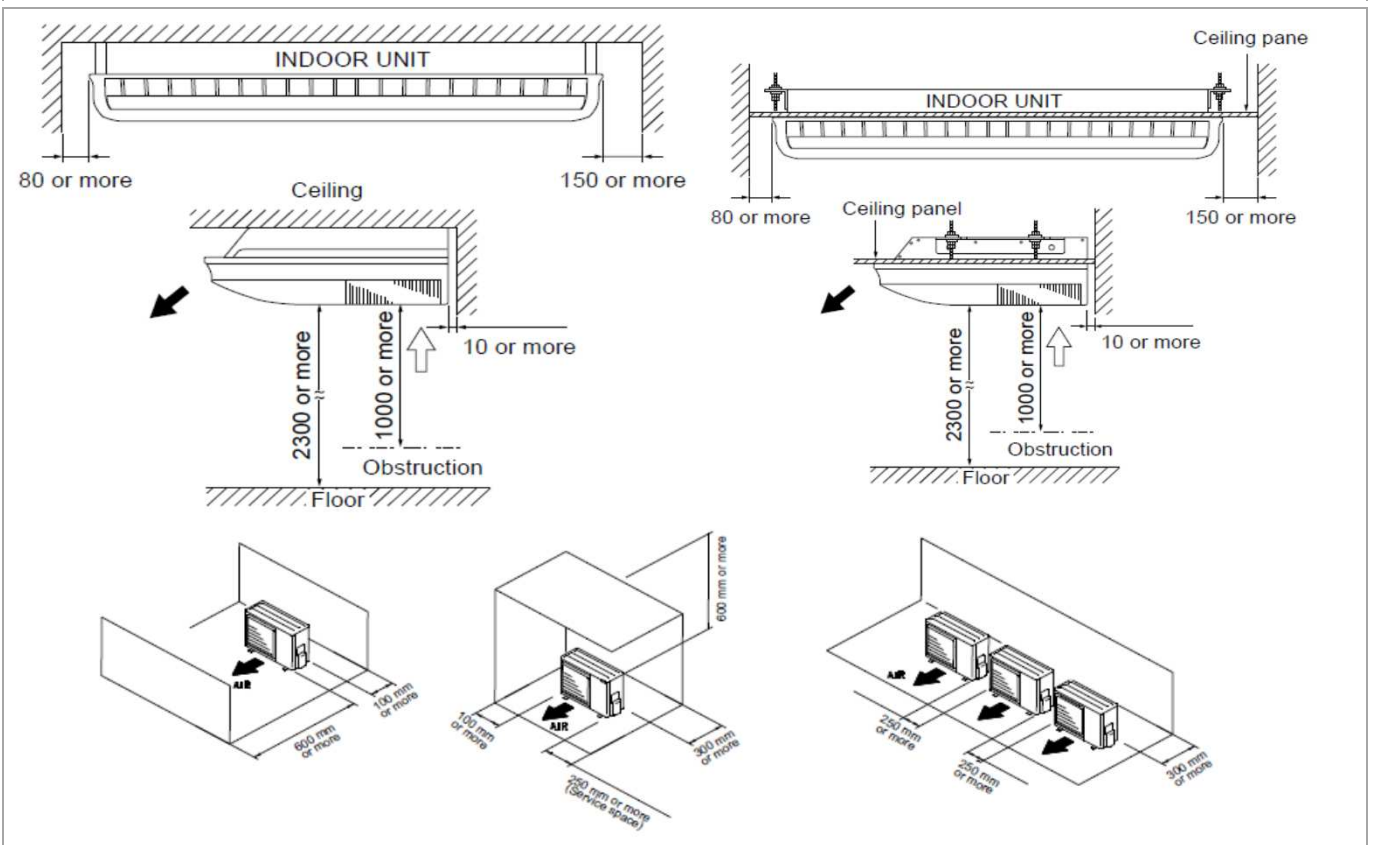

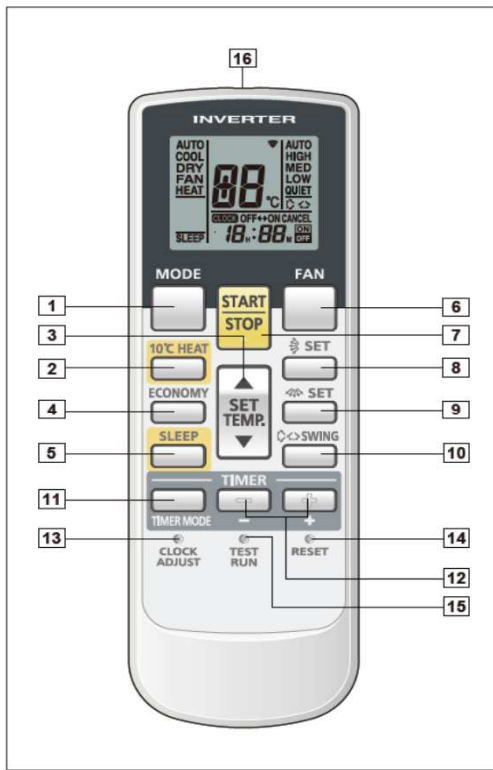

Display panel

- 1** **MODE button**
Selects the operating mode (AUTO, COOL, DRY, FAN, HEAT /Start / end R.C. signal code change. (Max 4 types)
- 2** **10°C HEAT button**
- 3** **SET TEMP. button (▲ / ▼)**
Sets the indoor temp./ Sets R.C. signal code.
- 4** **ECONOMY button**
- 5** **SLEEP button**
Pressed to select sleep timer.
- 6** **FAN button**
Selects the fan speed (AUTO, HIGH, MED, LOW, QUIET).
- 7** **START/STOP button**
Pressed to start and stop operation.
- 8** **SET button (Vertical)**
Air flow direction vertical set button.
- 9** **SET button (Horizontal)**
Air flow direction horizontal set button.
- 10** **SWING button**
Air flow direction swing button.
- 11** **TIMER MODE button**
Pressed to select the timer mode. (OFF TIMER, ON TIMER, PROGRAM TIMER, TIMER RESET)
- 12** **TIMER SET ([] / []) button**
Sets the current time and on-off time.
- 13** **CLOCK ADJUST button**
Sets the current time.
- 14** **RESET button**
Used when replacing batteries.
- 15** **TEST RUN button**
Used when testing the air conditioner after installation.
- 16** **Signal transmitter**

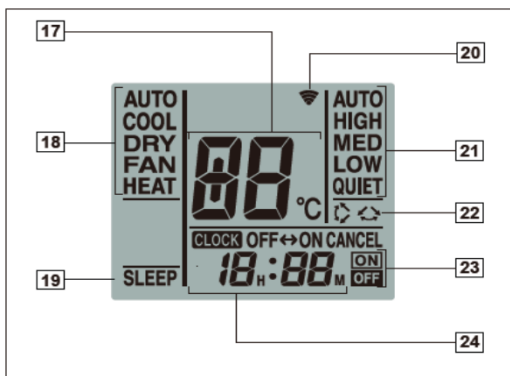

- 17** **Temperature set display**
- 18** **Operating mode display**
- 19** **Sleep display**
- 20** **Transmit indicator**
- 21** **Fan speed display**
- 22** **Swing display**
- 23** **Timer mode display**
- 24** **Clock display**

Note: Functions will be different due to type of indoor unit.
For details, please see operation manual.

| Bivalent temperature | | | | Operating limit temperature | | | |
|----------------------|--------|-------|------|-----------------------------|--------|-------|------|
| Item | Symbol | Value | Unit | Item | Symbol | Value | Unit |
| Heating/Average | Tbiv | -7 | °C | Heating/Average | Tol | -15 | °C |
| Heating/Warmer | Tbiv | N/A | °C | Heating/Warmer | Tol | N/A | °C |
| Heating/Colder | Tbiv | N/A | °C | Heating/Colder | Tol | N/A | °C |

| Cycling interval capacity | | | | Cycling interval efficiency | | | |
|---------------------------------|--------|-------|------|---------------------------------|--------|-------|------|
| Item | Symbol | Value | Unit | Item | Symbol | Value | Unit |
| For cooling | Pcyc | N/A | kW | For cooling | EERcyc | N/A | - |
| For heating | Pcyc | N/A | kW | For heating | COPcyc | N/A | - |
| Degradation coefficient cooling | Cdc | 0.25 | - | Degradation coefficient heating | Cdh | 0.25 | - |

| Electric power input in power modes other than 'active mode' | | | | Annual electricity consumption | | | |
|--|------------------|-----------|------|--------------------------------|-----------------|-------|-------|
| Item | Symbol | Value | Unit | Item | Symbol | Value | Unit |
| Off mode (Cooling/Heating) | P _{OFF} | 10.0/10.0 | W | Cooling | Q _{CE} | 548 | kWh/a |
| Standby mode (Cooling/Heating) | P _{SB} | 10.0/10.0 | W | Heating/Average | Q _{HE} | 2965 | kWh/a |
| Thermostat-off mode (Cooling/Heating) | P _{TO} | 3.0/9.0 | W | Heating/Warmer | Q _{HE} | N/A | kWh/a |
| Crankcase heater mode (Cooling/Heating) | P _{CK} | 0.0/0.0 | W | Heating/Colder | Q _{HE} | N/A | kWh/a |

| Capacity control | | Other items | | | |
|------------------|-----|------------------------------------|-----------------|-----------|-----------------------|
| Item | Y/N | Item | Symbol | Value | Unit |
| Fixed | No | Sound power level (Indoor/Outdoor) | L _{WA} | 60.0/69.0 | dB(A) |
| Staged | No | Global warming potential | GWP | 1975 | kgCO ₂ eq. |
| Variable | Yes | Rated air flow (Indoor/Outdoor) | - | 1900/3800 | m ³ /h |

| | |
|--|---|
| Contact details for obtaining more information | FUJITSU GENERAL LIMITED 1116, Suenaga, Takatsu-ku, Kawasaki, 213-8502, Japan |
|--|---|

V20121214



ENERG
енергия · ενεργεια

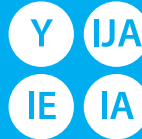

GENERAL

AOHG36LETL/ABHG36LRTE

SEER



A⁺

kW 9,4
SEER 6,0
kWh/annum 548

SCOP

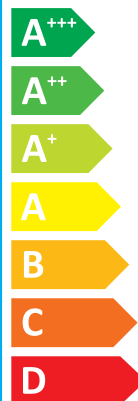

A⁺

| | | | |
|-----------|---|------|---|
| kW | X | 8,7 | X |
| SCOP | X | 4,1 | X |
| kWh/annum | X | 2965 | X |



60dB



69dB



ENERGIA · ЕНЕРГИЯ · ΕΝΕΡΓΕΙΑ · ENERGIJA · ENERGY · ENERGIE · ENERGI
626/2011