

- Certified according to ATEX
- Speed-controllable
- Integral thermistors (PTC *)

The DVEX models have impellers with backward-curved blades and external rotor motors. The casing is made from aluminium and the base frame from galvanised steel, with a copper inlet cone.

To protect the motor from overheating these fans have integral thermistors (PTC) with external leads which must be connected to the U-EK230E motor protection relay.

From size 315 up to 450 the tilting device FTG is premounted, at 560 and 630 available as accessory.

Explosions proof version comply with EN 60079-0, 60079-7, EN 1127-1 and EN 13463-1. Improved safety in accordance with Ex e IIB T3.

* Positive Temperature Coefficient



Technical parameters

Nominal data		
Voltage	230/400	V
Frequency	50	Hz
Phase	3	~
Input power (P1)	260	W
Current	0,81/0,47	A
Max. airflow	2480	m ³ /h
Fan impeller speed	1340	r.p.m.
Weight	28	kg
Temperature data		
Temperature range, ambient and duct	-20-40	°C
Sound data		
Sound pressure level at 4 m (free field)	49	dB(A)
Sound pressure level at 10 m (free field)	41	dB(A)
Protection / Classification		
Insulation class		F
Enclosure class, motor		IP44
Certificate		SP 07ATEX3130X
Explosion proof		II 2G c Ex e IIB T3
Default group		
Motor circuit connection		D/Y

Performance

Diagrams

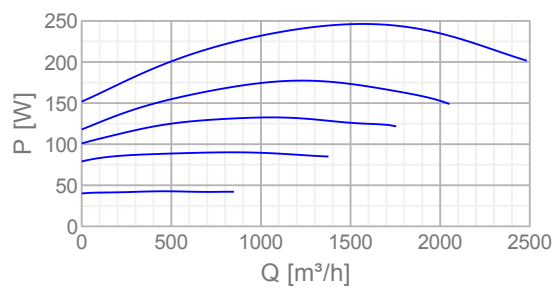
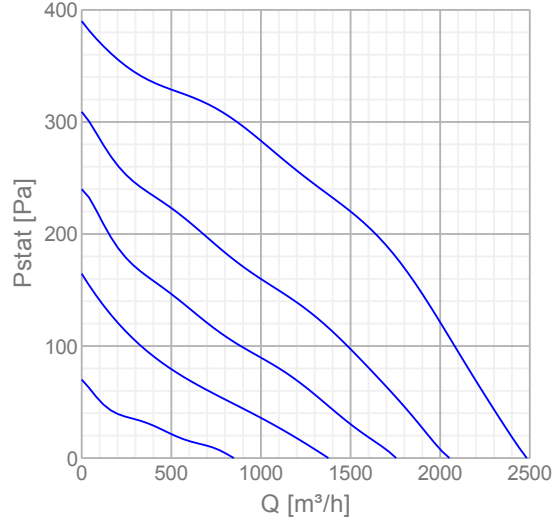

Wiring

230V3~ (D)



400V3~ (Y)

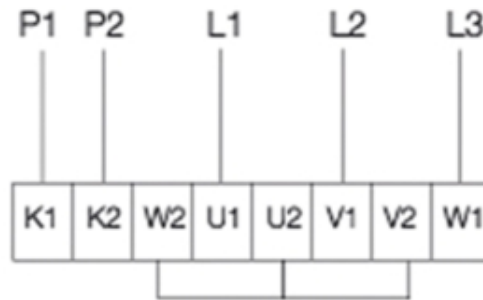

- U1 brown
- V1 blue
- W1 black
- U2 red
- V2 grey
- W2 orange
- K1 white
- K2 white

Dimensions

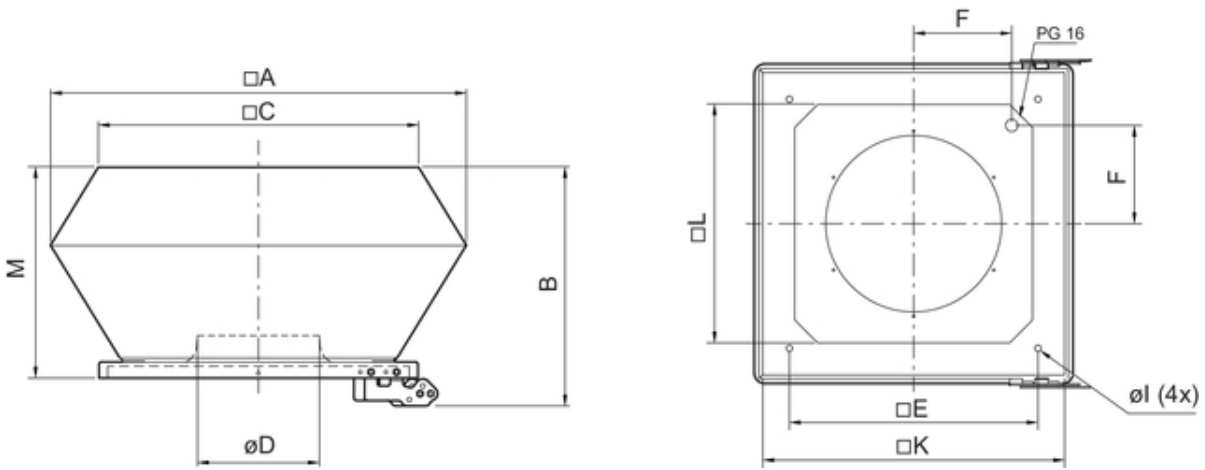

	$\square A$	B	$\square C$	$\square D$	$\square E$	F	$\square I$	$\square K$	$\square L$	M
DVEX 355	720	442	618	226	450	199	12	566	466	390